

## Noctambule Floor 1 Low Cylinder Small Base

Designed by Konstantin Grcic, 2019

18W - 485lm - 2700K



Standing lamps consisting of interconnecting glass modules reaching a height of 2,17 metres (85.43"). Cylindrical and semi-spherical transparent blown glass structure, die cast aluminium base and rings, hydroformed steel internal lateral arms and injection moulded optical opal silicone outer ring diffusers. The power supply cable is 2 metres (78.74") long, with a pedal operated panel used as a dimmer to adjust the light intensity by 10% to 100% in either direction. Wall mounted power supply unit with interchangeable plugs.

Are you a professional and your project needs consulting and support?

[BOOK AN APPOINTMENT](#)

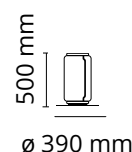

### Main specifications

|                        |                     |
|------------------------|---------------------|
| EAN                    | 8059607000847       |
| Mounting               | Floor               |
| Environments           | Indoor dry location |
| Light source type      | LED                 |
| Light sources included | Yes                 |
| LED type               | LED Module          |
| Power (W)              | 18                  |
| Lumen Output (lm)      | 485                 |

### Physical

|                     |       |
|---------------------|-------|
| Colour              | Black |
| Length (mm)         | 250   |
| Cord colour         | Black |
| Cord length (mm)    | 1800  |
| Net weight (kg)     | 10.3  |
| Package volume (m3) | 0.11  |
| IP internal         | 20    |

### Download

|                       |                              |
|-----------------------|------------------------------|
| Mounting instructions | <a href="#">Download PDF</a> |
| Mounting instructions | <a href="#">Download PDF</a> |

### Photometric Files

|           |                              |
|-----------|------------------------------|
| LDT / IES | <a href="#">Download ZIP</a> |
|-----------|------------------------------|

### Technical Drawings

|   |                              |
|---|------------------------------|
| 3D  | <a href="#">Download ZIP</a> |
|  Bim | <a href="#">Download ZIP</a> |

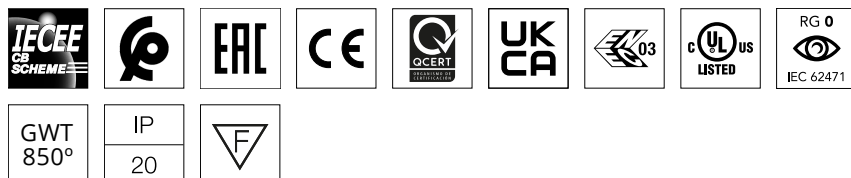

Schematic light drawing

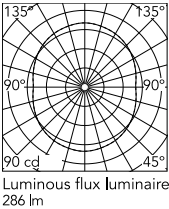

Photometric

|                    |           |
|--------------------|-----------|
| Lighting type      | Total     |
| Light distribution | Symmetric |
| CCT (K)            | 2700      |
| Extreme cut off    | No        |

Electrical

|                    |                        |
|--------------------|------------------------|
| Insulation class   | III                    |
| Frequency (Hz)     | 50/60                  |
| Main voltage (Vac) | 100-240                |
| Power supply       | Remote included        |
| Dimmable           | Yes                    |
| Power supply type  | Electronic 48V         |
| Dimming interface  | Dimmer Integrated      |
| Plug type          | Type G, Type A, Type C |
| Batteries inside   | No                     |

Ecodesign and Energy Labelling

This product contains a light source of energy efficiency class E

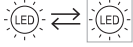
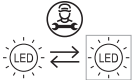

Replaceable (LED only) light source by a professional

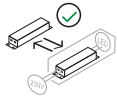

Replaceable control gear by an end-user

Spare Parts

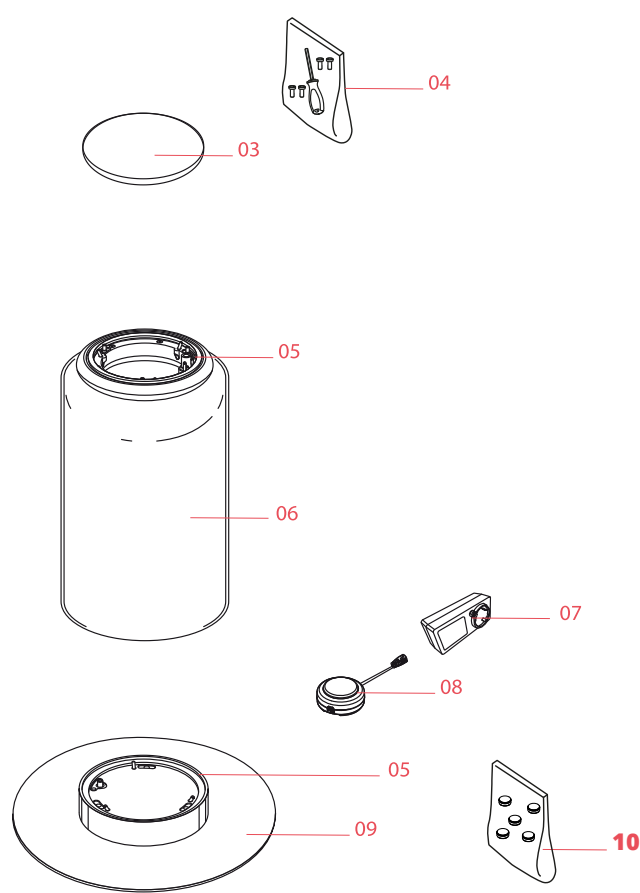

|     |   |           |
|-----|---|-----------|
| 03. | Noctambule Floor Terminal cap                       | F0293030  |
| 04. | Fixing screws kit                                   | RF0254100 |
| 05. | Ring led diffuser                                   | RF27498   |
| 06. | Noctambule Low Cylinder                             | F0254000  |
| 07. | Black plug assembly kit & 48V driver                | RF6600130 |
| 08. | Noctambule switch dimmer assembly (with EMC filter) | RF37082   |
| 09. | Noctambule Floor Small base                         | F0261030  |
| 10. | Noctambule F n°5 adjustable feet kit                | RF0254200 |



F0293030

Noctambule Floor Terminal cap



RF0254100

Fixing screws kit



RF27498

Ring led diffuser



F0254000

Noctambule Low Cylinder



RF6600130

Black plug assembly kit & 48V driver

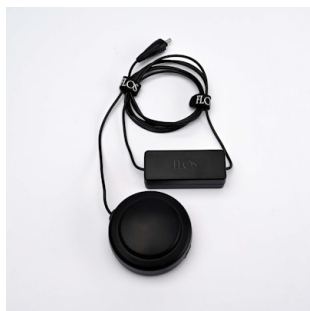

RF37082

Noctambule switch dimmer assembly (with EMC filter)



F0261030

Noctambule Floor Small base



RF0254200

Noctambule F n°5 adjustable feet kit